

Motor Yacht Titan

Luxury Mediterranean motor yacht Titan is one of only a select few yachts which are licensed/registered and available to charter with up to 22 charter guests accommodated in luxury. Titan's history actually began in 1968 as a Royal Navy research vessel. She was originally created by Brooke Marine and has recently undergone an extensive rebuild in 2004 and refit in 2008 to transform her into the superb luxury private charter yacht that she is today.



Yacht Charter Specifications

Type/Year: Mediterranean crewed yacht charter/1968/2004

Refit: 2004 **Beam:** 11.4m / 37.4 ft

L.O.A.: 60m / 198 ft **Crew:** 20

Charter Guest: 22 **Max Speed:** 12+ knots

Cabins: 11 **Engines:** 4 X 750 Lister Blackstone

Cruise Speed: 12 knots

The luxury yacht's interior is finished in a contemporary English style with beech wood and bird's eye maple. Her generous internal dimensions create an open, airy and light atmosphere. Titan's main saloon is a large space for entertaining and linking up with the saloon and includes a cinema screen ideal for the entertainment of small groups. Her upper deck provides a library, gymnasium and bar with a fantastic sky lounge which opens out, via automatic doors, to a lovely shady terrace. Her main deck can seat 18 guests comfortably for external dining.



All spaces have been studied to supply the highest comfort and privacy while bringing a distinguished Italian style. Luxury motor yacht Titan is available for charter throughout the Mediterranean.

TITAN was born as a survey ship from the English Marine to become in 2003 a luxury yacht. During the complete refitting and refurbishing, a particular care was given to the choice of materials. The use of pear-tree essence for the wooden structures (from saloons to cabins) has given the ship an elegant and comfortable touch. TITAN is not just a simple yacht but a motor vessel able to welcome 22 guests on board with 21 select crew members always at the ready.

The wi-fi internet connection system is able to reach every corner of the vessel while the big projector screen transforms the main saloon into a home cinema. The open decks have been

designed to guarantee a pleasant stay thanks to a spacious Jacuzzi, a well equipped gym and a comfortable and elegant sun deck with a bar and barbecue.

TITAN's EXTRAS:

Dining table inside for up to 16 guests

Extendable alfresco dining table for up to 16/18 people. 2 extra tables (4 seater) can be added on either side.

Additional table on the sun deck for 4 people

1 sky bar with barbecue and ice maker

1 private library

Gym: Treadmill, bicycle, power plate, weights, massage table (tecnogym).

Luxury yacht TITAN went through a major exterior refit in 07/08. The hull was repainted blue Boero (opac finish/semilucida) and the exterior is being retouched in white. An additional sun deck was added with a bar and a barbecue. The interior was refitted last winter by the Owner; new fabric, new furniture...etc. This new interior has a very welcoming and luxurious touch with an Italian twist. The Owner took special care in choosing the fabrics and the decorative elements. SUN DECK: New tables 2m long. New cushions for the sun beds New bar New 3 x square parasols New Jacuzzi Working on creating an indoor small spa area with gym.

AFT main deck The aft has been extended (lengthened) to give more guest space The platform is 1m longer (teak) 2 stairs leading to the platform have been replaced. New swim ladder Pincraft FORWARD New tenders: 2 x Alson 7.50m New crane for jet skis (500kg) New crane for tenders (2000 kg) WHEELHOUSE Replacement of 2 Furuno radars (latest generation) Replacement of 2 gyrocompasses Sperry Marine (latest generation) Replacement of the magnetic compass Plath (latest generation) Wireless internet all over ENGINE ROOM Review of the generators, main engines, bow thrusters, air conditioning, fridges, pumps ...etc. EXTRAS: The kitchen has received some refitting as well; ventilation, hydraulics and various electrical items.





Yacht Charter Accommodation

Mediterranean luxury yacht Titan accommodates 22 charter guests comfortably in six double and five twin large and light staterooms. Guest Accommodation -Master cabin: Upper deck. King size +. Private salon and his & hers bathroom. Shower + tub with hydromassage. -5 double cabins: 2 main deck and 3 lower deck. (VIP - tub) -5 twin cabins: 3 main deck and 2 lower deck. Showers. All cabins are equipped with phones for interior and exterior calls. MAIN DECK Main salon with ample seating area on both sides. Home cinema with a sliding down screen a projector (connected to a DVD player and SKY). Dining table for up to 14/16 guests. 2 double cabins and 3 twin cabins forward. Galley & pantry. LOWER DECK 2 double cabins, 1 VIP with tub and 2 twins. The cabins are connected through 2 stairsways, one at the aft entrance, and another by the dining table. UPPER DECK Upper deck salon with large bar. Private salon in the back. Alfresco dining for up to 16/18. 1 side table for 4. Seated area. Master cabin forward with Owner salon. SUNDECK Large sun beds (fixed). 1 table for 4. One Jacuzzi. Gym with a treadmill, bicycle, elliptical machine, power plate, weights, mats, massage table (all tecnogym). UPPER SUNDECK Brand new addition. Bar with a barbecue, ice maker and fridge. Comfortable seating area forward with large parasols. 2 sun chairs.



Charter Amenities and Extras

Luxury Motor Yacht TITAN has the following: Tenders & Toys Tenders: 2 x Alson flash 750 powered Evinrude e-tech 225 DHX Jet-skis: 2 x Yamaha 900 STX Diving gear: 4 sets of scuba diving gear Dive-air compressor: 1 x for re-filling of scuba tanks and breathing air bottles bananas, water ski, ski board, canoes Safety Equipment -Rescue boats: 2 x Zodiac rescue boat fully equipped acc. to SOLAS regulations -Life-rafts: 6 x 25 persons SOLAS: Ship is fully equipped and certified according SOLAS rules for passenger ships to 24 passengers Audio Visual Equipment and Deck Facilities Entertainment: Bose surround sound in main salon, sky bar, library, Sky TV and DVD in all cabins and library Cinema screen with beamer in main saloon Extensive DVD, games and book library Ipod docking stations (main salon, sky bar, fly deck, gym) GYM 1 treadmill 1 Bicycle with TV screen 1 bench 1 power plate 2 sets of weights 1 elliptical machine Mats Ball Stereo I-pod 26 Communications BRIDGE EQUIPMENT Radar: 2 x FURUNO ARPA (2008) Ais: Furuno FA 150 Autopilot: Cetrek Echosounder: 2 x Raymarine (forward and aft) P/A system: Covering all decks, selected areas announcements possible GPS:2 x CCTV: 3 cameras Ship handling: 3 x control-stations for controllable pitch propeller and bow thruster COMMUNICATION/RADIO GMDSS: Fully equipped for unlimited trading areas Satellite phone/fax: 2 x fleet 77, 1 x sat Telex Telephone exchange TDA 200 PANASONIC MF/HF with DSC: 1 x furuno Navtext: 1 x furuno Fixed VHF with DCS:1 x skanti, 1 x shipmate Handheld VHF: 6 x Icom + 3 x navico (emergency only) SART: 2 x pathfinder EPIRP: 2 X ACR satellite 2 406 COMPUTER SYSTEM LAN: 4 administrator PC, Peer to Peer W-LAN: covering of all decks Internet: Wifi





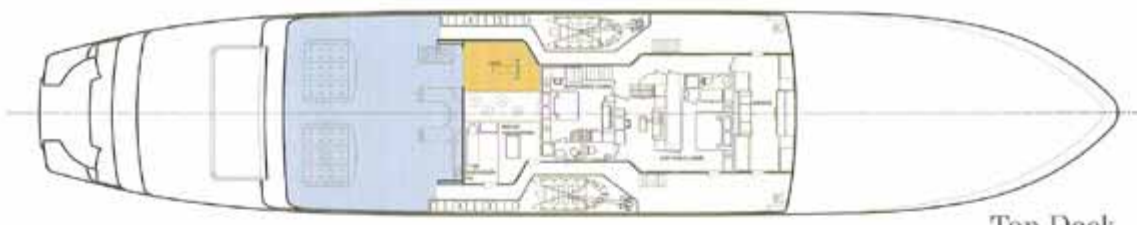

Top Deck

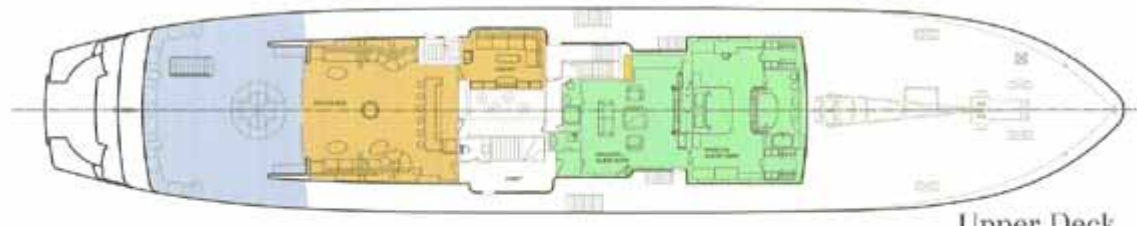

Upper Deck



Main Deck



Lower Deck

Guest Saloons ■
 Guest Cabins ■
 Guest Sun Decks ■